

▼ From left to right: VLP-506GPECW, VLP-1006GPERW, VLP-106P142, VLP-256PAT1



- Quality welded frame for maximum strength and stability
- Optimum daylight and bed width
- With hand pump, air or electric driven power source
- Single or double-acting GOLDEN RING DESIGN cylinders
- Standard glycerine filled gauge with dual scale reading in kN and bar
- Moveable pump table on presses with electric pump allows for easy side loading for large workpieces
- Height adjustment of lower bed on 25 ton press with a winch
- Unique "Hydrajust" bed positioning device on 50, 100 and 200 ton press with double-acting cylinder allows adjustment of the lower bed

No Workshop can do without one



V-Blocks

To facilitate positioning of pipes and bars, or placed upside-down, to serve as a convenient worktable.

Featuring precise fit into the press bolster. Each model number includes two V-blocks.

To be used with VLP-press ton	V-Blocks Model Number
10	VB-10
25	VB-25
50	VB-501
100	VB-101
200	VB-200

Page: 134





Centered Manual Valves

Manual 3-position valves on electric Hushh pumps (GPEC-models) supplied on VLP-series presses

automatically move to the tandem centre position for safety reasons.

▼ SELECTION CHART

Press Capacity ton (kN)	Maximum Daylight (mm)		Press Model Number	Power Source						Cylinder						
	Vertical	Horizontal		Pump Type			Valve Type			Pump Model Nr.	Page:			Stroke (mm)	Cylinder Model Nr.	Page:
				Man.	Elec.	Air	Man.	Elec.								
10 (101)	430	432	VLP-106P142	•			•			P-142	56	•		155	RC-106	8
	430	432	VLP-106PAT1			•	•			PATG-1102N	86	•		155	RC-106	8
25 (232)	1225	510	VLP-256P392	•			•			P-392	56	•		159	RC-256	8
	1225	510	VLP-256PAT1			•	•			PATG-1102N	86	•		159	RC-256	8
50 (498)	994	1000	VLP-506P802	•			•			P-802	58	•		159	RC-506	8
	994	1000	VLP-506GPERW		•			•		GPER-5410WSN	74		•	155	RR-506	26
	994	1000	VLP-506GPECW		•		•			GPEC-5410WSN	74		•	155	RR-506	26
	994	1000	VLP-5013GPERW		•			•		GPER-5410WSN	74		•	333	RR-5013	26
100 (933)	989	1000	VLP-1006GPECW		•		•			GPEC-2410WN	74		•	168	RR-1006	26
	989	1000	VLP-1006GPERW		•			•		GPER-2410WN	74		•	168	RR-1006	26
	989	1000	VLP-10013GPERW		•			•		GPER-2410WN	74		•	333	RR-10013	26
200 ¹⁾	1340	1220	VLP-20013GPERW		•			•		GPER-3420WN	74		•	333	RR-20013	26

¹⁾ 1995 kN



= Single-Acting



= Double acting

Bench and Workshop Presses



Press Gauges

All presses include a gauge and gauge adaptor, matching the press capacity.

Press Capacity ton	Gauge Model Number	Adaptor Model Number
10	GF-10B	GA-4
25	GF-20B	GA-2
50	GF-50B	GA-2
100	GF-871B	GA-3
200	GF-200B	GA-2

Page: 112



"Hydrajust" Bed Positioning

Allows vertical adjustment of the lower bed on the 50, 100 and 200 ton VLP press.



The "Hydrajust" bed positioning is not designed to withstand full cylinder capacity, only to be used for bed adjustment.

Page: 134

VLP Series



Capacity:

10 - 200 ton

Maximum Daylight x Width:

1340 x 1220 mm

Maximum Operating Pressure:

700 bar

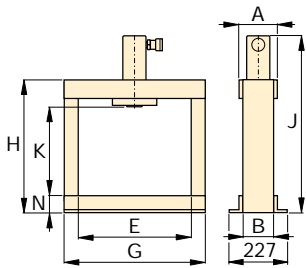

VLP 10 ton Bench

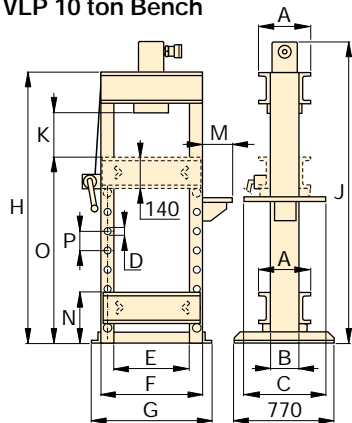

VLP 25 ton

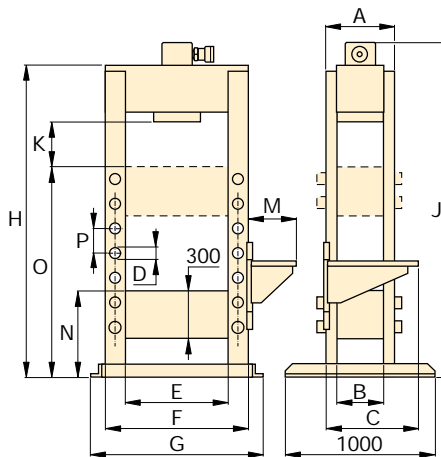

VLP 50 and 100 ton

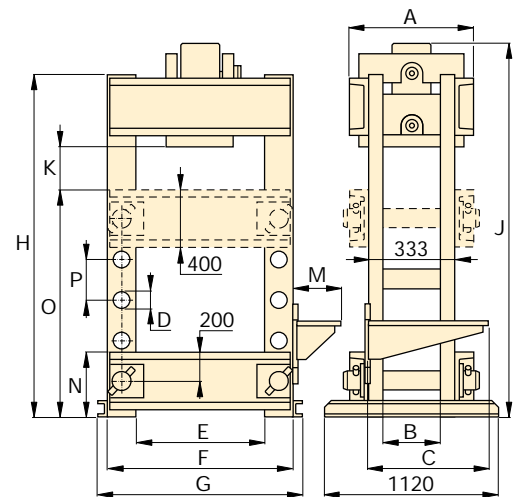

VLP 200 ton

Speed (mm/sec)*		Dimensions (mm)															Press Model Number
Rapid Advance	Pressing	A	B	C	D	E	F	G	H	J	K	M	N	O	P	(kg)	
{2,5}*	{0,6}*	110	80	-	-	432	-	542	620	748	430	-	80	-	-	50	VLP-106P142
10,0	1,8	110	80	-	-	432	-	542	620	748	430	-	80	-	-	55	VLP-106PAT1
{3,4}*	{0,7}*	260	140	510	32	510	630	700	1622	1740	370	140	212	1070	122	160	VLP-256P392
5,0	0,8	260	140	610	32	510	630	700	1622	1740	370	323	212	1070	122	165	VLP-256PAT1
{5,5}*	{0,3}*	290	250	560	32	990	1200	1360	1879	1879	244	425	540	1290	150	620	VLP-506P802
3,8	3,8	290	250	560	32	990	1200	1360	1879	1879	244	425	540	1290	150	670	VLP-506GPERW
3,8	3,8	290	250	560	32	990	1200	1360	1879	1879	244	425	540	1290	150	685	VLP-506GPECW
3,8	3,8	290	250	560	32	990	1200	1360	1879	2042	244	425	540	1290	150	692	VLP-5013GPERW
6,4	0,7	400	340	560	40	990	1240	1400	1879	1885	239	425	540	1290	150	960	VLP-1006GPECW
6,4	0,7	400	340	560	40	990	1240	1400	1879	1885	239	425	540	1290	150	970	VLP-1006GPERW
6,4	0,7	400	340	560	40	990	1240	1400	1879	2050	239	425	540	1290	150	1010	VLP-10013GPERW
5,1	0,5	553	233	560	76	1220	1620	1740	2285	2370	377	425	453	1415	254	2000	VLP-20013GPERW

* {...} = advance speed in mm per handpump stroke.