

ENERPAC 

Pivoting T-Arms



01_095

ENERPAC[®]
WORKHOLDING



Increase your quality and production

Now two workpieces can be
clamped simultaneously with
only one swing cylinder.

Pivoting T-Arms *for double-acting swing cylinders*

Shown: CAC-202, CAPT-202; CAC-352, CAPT-352



01_001

▶ **Clamp arms are used to transmit the force generated by the swing cylinder to the workpiece. The T-arm clamps two workpieces simultaneously with one swing cylinder. Enerpac recommend to use the pivoting T-arms with double-acting swing cylinders of the SU, SL, ST and SC-series.**

Clamping two workpieces with one cylinder

...quick and precise clamp arm positioning

- T-arms are used to clamp two workpieces
- Pivoting clamp arm compensates large differences in workpiece height
- The clamp arm design allows quick random positioning
- CAC series collar can be installed without removing the cylinder from the fixture
- Silicone spring is compatible with all coolants and protects against contamination
- Simple design allows easy creation of your own T-arm

! Allowable flow vs arm length

The distribution of the clamp arm force is based upon the length of the T-arm as measured from the pivoting point.

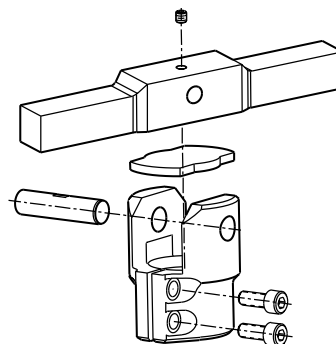

! Important

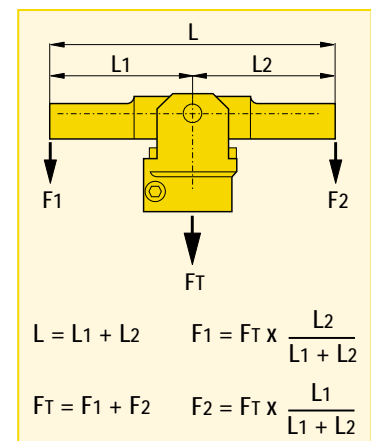

■ *Two workpieces are clamped simultaneously with one double-acting swing cylinder by using the Enerpac pivoting T-arm.*



01_002

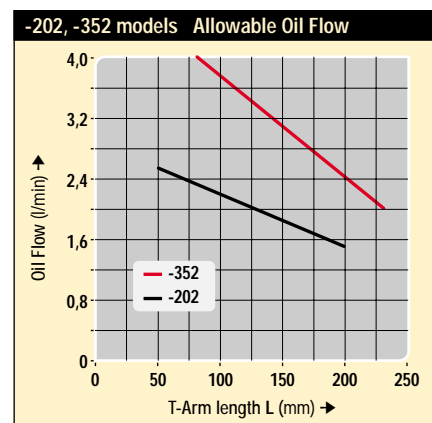
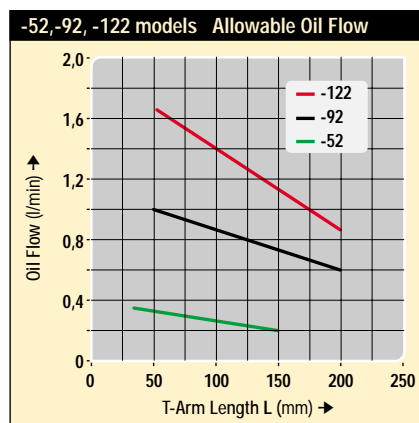



Shown: CAC-202



CAC models Collars for T-arms

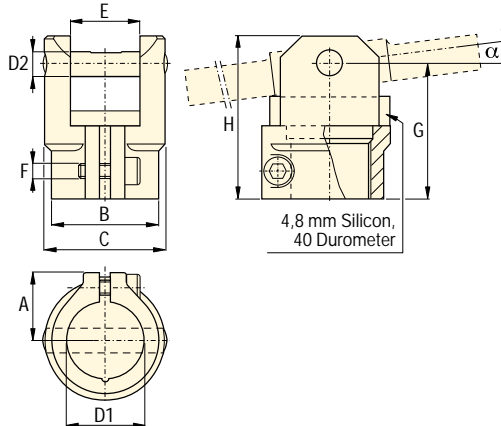

Collars - Dimensions in mm [D]

Clamp. force kN	Model number	Max. Tilt Angle α	A	B	C	D1	D2	E	F	G	H	kg
5,6	CAC-52	20°	16,5	24,0	28,0	16,0	6,0	16,1	M4x0,7	32,0	40,0	0,09
9,0	CAC-92	14°	22,0	34,6	39,0	25,0	8,0	22,5	M5x0,8	43,2	52,6	0,20
11,6	CAC-122	14°	22,0	34,6	39,0	22,3	8,0	22,5	M5x0,8	43,2	52,6	0,20
18,7	CAC-202	10°	27,2	46,6	54,5	32,0	10,0	28,8	M6x1,0	51,2	63,0	0,47
33,8	CAC-352	10°	34,0	54,6	63,0	38,0	14,0	35,2	M8x1,25	63,4	79,0	0,80

Shown: CAPT-202



CAPT models T-arms (for SU, SL, ST and SC swing cylinders)

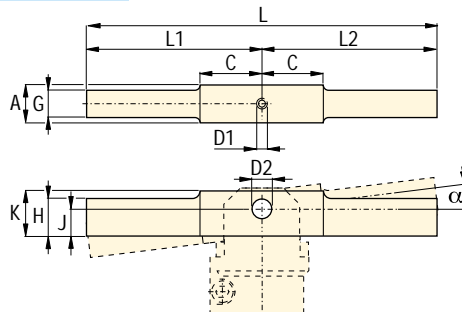

T-Arms - Dimensions in mm [D]

Clamp. force kN	Model number	A	C	D1	D2*	G	H	J	K	L	L1	L2	kg
5,6	CAPT-52	15,6	25,5	M3x0,5	6,02-6,12	12,7	12,7	10,0	19,0	152,4	76,2	76,2	0,27
9,0	CAPT-92	22,0	38,1	M4x0,7	8,02-8,12	18,3	18,3	15,1	22,2	203,2	101,6	101,6	0,66
11,6	CAPT-122	22,0	38,1	M4x0,7	8,02-8,12	18,3	18,3	15,1	22,2	203,2	101,6	101,6	0,66
18,7	CAPT-202	28,3	31,8	M6x1,0	10,02-10,12	22,0	22,0	16,2	28,6	203,2	101,6	101,6	0,96
33,8	CAPT-352	34,7	25,0	M6x1,0	14,02-14,12	30,0	30,0	18,4	34,8	228,6	114,3	114,3	1,78

* Note: D1 equals set screw thread size. Set screw must be long enough to secure the pivot pin.

Installation dimensions in mm [D]

Clamping force kN	Swing cyl. and T-arm model	SU-series C	SL-series C	ST-series C	SC-series C
T-arm installation dimensions - Fully unclamped position					
5,6	52	73,7	139,7	73,7	81,0
9,0	92	79,5	155,5	84,6	-
11,6	122	90,2	176,0	90,2	98,3
18,7	202	90,7	177,5	90,7	-
33,8	352	102,6	199,1	109,5	-

Important: Dimensions C are for swing cylinder in the fully unclamped positions.

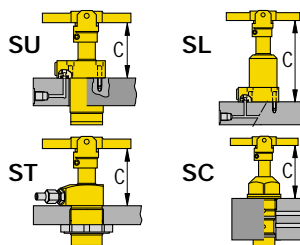

Force: 5,6 - 33,8 kN
Pressure: 35 - 350 bar

- (E) Brazos de amarre
- (F) Bras de bridage
- (D) Spannarme

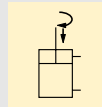

Options

Gauges



Flow control valves



Download CAD files from www.enerpac.com



Important

Do not exceed maximum oil flow

If flow rates are exceeded, swing cylinder indexing mechanism may be permanently damaged.

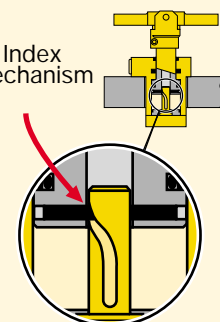

When designing custom clamp arms, the flow rates must be further reduced. This rating should be in proportion to the mass and the angular momentum of the clamp arm.

Example:

If the mass of the arm is twice that of the long arm, flow rates must be reduced by 50%.

Pivoting T-Arms

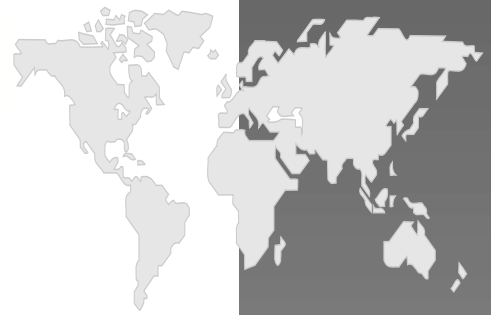

ENERPAC

The complete line

Swing Cylinders and Work Supports

- Upper flange swing cylinders
- Lower flange swing cylinders
- Threaded body swing cylinders
- Cartridge model swing cylinders
- Positive locking swing cylinders (*Collet-Lok*®)
- Clamp arms for swing cylinders
- Special swing cylinders
- Hydraulic advance work supports
- Spring advance work supports
- Positive locking work supports (*Collet-Lok*®)

Pull and Linear Cylinders

- Pull cylinders
- Threaded cylinders
- Manifold cylinders
- Block cylinders
- Pull down clamps
- Hollow plunger cylinders
- Positive clamping cylinders
- Universal cylinders

Power Sources

- Air hydraulic pumps
- Electric driven pumps
- Hand pumps
- Boosters
- Pressure intensifiers

Valves

- Directional control valves
- Flow control valves
- Pressure control valves
- Sequence valves
- Manifolds
- Accessory and Air valves

System Components

- Auto-coupler systems
- Rotary couplers
- Accumulators
- Pressure switches
- Gauges and accessories
- Hoses, Couplers, Manifolds
- Pressure Filters, Oil
- Fittings



Ask now for the new **E211e Workholding Catalogue**. Including all Workholding files on CD.

Enerpac Worldwide Locations

Australia

ENERPAC, Applied Power Australia Ltd.
Block V Unit 3
Regents Park Estate
391 Park Road
Regents Park NSW 2143
(P.O. Box 261) Australia
Tel: +61 297 438 988
Fax: +61 297 438 648

Canada

Applied Power Canada Ltd.
6615 Ordan Drive, Unit 14-15
Mississauga, Ontario L5T 1X2
Tel: +1 905 564 5749
Fax: +1 905 564 0305
Toll Free:
Tel: +1 800 268 4987
Fax: +1 800 461 2456

China

Applied Power China Ltd.
1F, 269 Fute N. Road
Waigaoqiao Free Trade Zone
Pudong New District
Shanghai, 200 131
China
Tel: +86 21 5866 9099
Fax: +86 21 5866 7156

France, Turkey, Greece, Africa, Middle East

ENERPAC S.A.
B.P. 200
Parc d'Activités
du Moulin de Massy
F-91882 Massy CEDEX (Paris)
France
Tel: +33 1 601 368 68
Fax: +33 1 692 037 50

Germany, Switzerland, Austria, Eastern Europe

ENERPAC
Applied Power GmbH
P.O. Box 300113
D-40401 Düsseldorf
Germany
Tel: +49 211 471 490
Fax: +49 211 471 49 28

Hong Kong

ENERPAC
Room 907 Workingberg
Commercial Building
41-47 Marble Road
North Point
Tel: +852-2561 6295
Fax: +852-2561 6772

India

ENERPAC
Hydraulics (India) Pvt Ltd
Plot No. A-571
MIDC, TTC Industrial Area
Mahape-400 701
Navi Mumbai, India
Tel: +91 22 769 47 78
Fax: +91 22 769 84 73

Italy

ENERPAC
Applied Power Italiana S.p.A.
Via Canova 4
20094 Corsico (Milano)
Tel: +39 2 486 111 00
Fax: +39 2 486 012 88

Japan

Applied Power Japan Ltd.
1-1-11, Shimomae
Toda-shi, Saitama Pref.
Japan 335-0016
Tel: +81-048-430-2311
Fax: +81-048-430-1117

Mexico

ENERPAC Applied Power Mexico S.A. de C.V.
Avenida Principal, La Paz #100
Fracc. Industrial La Paz
42092 Pachuca, Hidalgo
Tel: +52 771 337 00
Fax: +52 771 838 00

The Netherlands, Belgium, Luxembourg, Sweden, Denmark, Norway, Finland

ENERPAC B.V.
Storkstraat 25 /
P.O. Box 269, 3900 AG
Veenendaal, The Netherlands
Tel: +31 318 535 911
Fax: +31 318 525 613
+31 318 535 848

Singapore

Applied Power Asia Pte Ltd
No. 8, Ang Mo Kio,
Industrial Park 2, #01-00
Singapore 569500
Thomson Road
P.O. Box 114
Singapore 915704
Tel: +65 484 5108
Fax: +65 484 5669

South Korea

ENERPAC
Applied Power Korea Ltd.
163-12 Dodang-Dong
Wonmi-Ku, Buchun-shi
Kyunggi-Do
Republic of Korea
Tel: +82 32 675 08 36
Fax: +82 32 675 30 02/73

Spain, Portugal

ENERPAC
Applied Power International S.A.
Avda. Camino de lo Cortao
21 - Nave 3
San Sebastian de los Reyes
28709 Madrid, Spain
Tel: +34 91 661 11 25
Fax: +34 91 661 47 89

United Kingdom, Ireland

ENERPAC Limited
Unit 3, Colemeadow Road
North Moons Moat
Redditch, Worcester B98 9BP
United Kingdom
Tel: +44 01527 598 900
Fax: +44 01527 585 500

USA, Latin America and Caribbean

ENERPAC
P.O. Box 3241
6101 N. Baker Road
Milwaukee, WI 53209 USA
Tel: +1 262 781 6600
Fax: +1 262 781 1049

User inquiries:

+1 800 433 2766
Distributor inquiries/orders:
+1 800 558 0530

Ref:Dec-22-2000E

e-mail:
info@enerpac.com
Internet:
www.enerpac.com

Your Enerpac Distributor: